

DUNDEE CITY COUNCIL

REPORT TO: Leisure And Arts Services Committee – 23 August 2004

REPORT ON: Camperdown Country Park Development Plan

REPORT BY: Director Of Leisure And Arts

REPORT NO: 295-2004

1.0 PURPOSE

1.1 To consider proposals for the long term development of Camperdown Country Park.

2.0 RECOMMENDATIONS

2.1 It is recommended that Members agree the attached proposals for the long term development of Camperdown Country Park

3.0 FINANCIAL IMPLICATIONS

3.1 There are allowances of £1,167,000 in the Leisure and Arts 3 years Capital Plan which will allow the progression of key early development proposals contained within this report. Later phases of the Development Plan will be funded through a combination of external funding and future years Capital Plan commitment.

4.0 EQUAL OPPORTUNITIES IMPLICATIONS

4.1 All communities throughout Dundee will have access to the developments outlined within this report.

5.0 LOCAL AGENDA 21 IMPLICATIONS

5.1 The development of Camperdown Country Park will ensure that the diversity of nature is valued and protected and that places, spaces and objects combine meaning with beauty and utility. Local needs will be met locally. The development will ensure that resources are used efficiently and waste is minimised. It will also make sure that opportunities for culture, leisure and recreation are readily available to all.

6.0 BACKGROUND

6.1 Camperdown Country Park is the largest public park in Dundee and owes its name and fame to the victory of Admiral Adam Duncan over the Dutch fleet in 1797 at the Battle of Camperdown, off the Dutch coast. The park which is home to no fewer than 190 species of trees, was opened to the public in 1949. Camperdown incorporates, within its boundaries: Camperdown Country Park; Templeton Woods – a haven for wildlife and a great location for woodland activities; and Clatto Reservoir – Dundee's centre for outdoor watersports.

6.2 Camperdown Country Park provides a significant mix of attractors. These include:-

- family attractions including wildlife centre and fun fair
- water based and outdoor sporting provision
- children's activities
- countryside and environmental activities and programmes
- cultural heritage provision
- active recreational pursuits
- leisure and sports provision including a championship golf course

- Dundee's most significant and largest green space
- Major events including Easter Fun Day and the Dundee Flower and Food Festival

6.3 In approaching the management and development of country parks, a long-term approach is necessary. Country parks evolve over many decades and Camperdown Country Park is now a mature and significant regional facility. As such the philosophies under - pinning the development proposals are;

- protection of a mature country park providing a wide range of facilities
- consolidation of the country parks various roles through targeted development
- a focus on effectively marketing the facilities as a major regional resource (copies of the recently produced country parks marketing leaflet have been circulated to Members separately).

7.0 CAMPERDOWN COUNTRY PARK DEVELOPMENT PLAN

The Country Park Development Plan focuses on development of its key functions which include provision for:- family attractions; sport and recreation; the great outdoors; heritage; leisure; watersports centre and woodland natural habitats. A plan showing these developments is attached at Appendix 1.

7.1 Family Attractions

The aspiration is to consolidate the range of family based attractions available within Camperdown Country Park which will in combination provide a "must see" family day out. The family attractions consist of:

7.1.1 **Wildlife Centre**

The Wildlife Centre is one of Dundee's most popular attractions and is home to around 50 species of animals, birds and reptiles. The Centre provides Tayside's only registered zoo. The Wildlife Centre is currently being redeveloped and branded around three key wildlife zones: The Danger Zone – all the animals in this area can kill or eat you; The Adventure Zone – providing an exciting activity adventure area including bison, deer, wallabies and tree climbing primates; and The Kids Zone – with opportunities for play and interaction with domestic and smaller animals.

Key development proposals include;

- New Bear enclosure as centrepiece of The Danger Zone
- New indoor education centre
- Introduction of tree-top walkway through The Adventure Zone
- New entrance, retail and catering area

7.1.2 **Adventure Playground**

Camperdown Country Park provides the City's major free adventure play area. This has been extensively developed with the introduction of state of the art children's play provision around a nautical theme reflecting the Battle of Camperdown, as well as the award winning "Sensory Garden" providing play designed to stimulate visitors with particular attention to sight, smell and feel. There is also an area of specially adapted play equipment.

7.1.3 **Family Fun Fair**

A Fun Fair consisting of family based attractions has been established within the Family Attractions Area in conjunction with Hornes Enterprises. This provides a range of paid attractions including a children's roller coaster, dodgems, mini train, pedallo boats, trampolines and mini cars.

Key development proposals include:

- The introduction of a water based family ride (e.g. log flume)
- The development of more permanent infrastructure

7.1.4 **Indoor Play Barn and Café**

It is proposed to explore the potential to develop an indoor play barn which would provide a complimentary

wet weather family attraction. The barn would be combined with an indoor/outdoor café area overlooking the existing boating pond to serve the Family Attraction Area. Enhanced public toilet provision would also be included.

Key development proposals include;

- Development of an indoor play barn in partnership with Hornes Enterprises

Master plans outlining the proposals for the Wildlife Centre, Family Fun Fair and Adventure Playground are provided at Appendix 2 and 3.

7.2 **Sport and Recreation**

Camperdown Country Park provides the City's major green space with a wide range of opportunities for physical activity, active sport and recreational pursuits.

7.2.1 **Camperdown Golf Course**

Camperdown Golf Course is an 18 hole championship course provided in a mature woodland setting. Development of the course is currently underway to enhance greens and tees and introduce new features. Consideration is also being given to enhancing visitor facilities.

7.2.2 **Walking**

The Country Park provides an extensive network of walks through open countryside and woodland. This network is currently being consolidated and further developed with assistance from Paths for All.

7.2.3 **Cycling**

The Country Park provides an extensive network of cycling routes with part of the City's Green Circular travelling through Camperdown, Templeton and Clatto. Work is currently underway to upgrade existing pathways and construct new link paths to extend the network. A cycling centre has recently been established providing cycle hire during the summer season.

7.2.4 **Other Sports and Seasonal Facilities**

The Park provides seasonal facilities for football, tennis, pitch and putt and putting.

7.2.5 **Sport and Recreation Development Proposals**

Key development proposals include;

- Extension of the paths network for cycling and walking
- Development of multi-sports surface area to enhance the tennis court into a year round multi-sport facility.
- Development of golf course, focussing on greens, tees and new features.
- Exploration of golf facility development including golf driving range and visitor facilities.
- Enhanced visitor marketing of Camperdown Golf Course.

7.3 **The Great Outdoors**

Camperdown Country Park has a wide range of natural environments including open grassland, parkland with scattered trees, open mixed woodland and plantation woodlands.

Most of the mature trees in the parkland and woods of Camperdown were planted by the first earl's forester, David Taylor including the famous Camperdown Elm. Other areas of environmental interest include:-

- Her Ladyship's Walk containing unusual evergreen trees.
- Red squirrels, rare in Scotland but still seen on a regular basis in Camperdown Country Park
- Roe deer can also be seen around the perimeter path.

Based in Camperdown Country Park but operating city-wide, the Countryside Rangers assist in the

interpretation of the natural environment of Camperdown Country Park.

Key development proposals include:-

- An environmental and landscape assessment of the natural environment and landscape features within the park – leading to a design plan for the natural and landscape environment.

7.4 **Events**

Camperdown Country Park provides the City's major outdoor events arena, hosting a range of major events. The most significant is the annual Flower and Food Festival, attracting around 25,000 people. The potential is there, following investment in infrastructure, to provide a further programme of major events throughout the year.

Key development proposals include;

- The development of new major outdoor events including the potential for a music based annual event.
- Enhancement of infrastructure to support events.

7.5 **Heritage: Camperdown House**

This neo-classical house was built in 1828 and was designed by the architect William Burn. It was named after the Battle of Camperdown with the Duncan family using the pensions granted by a grateful British government, to build this magnificent house.

Part of the house is currently open with a temporary exhibition and café on a seasonal basis.

The House provides significant development potential to provide public access to this significant historical house and also to Maritime Collections relating to the Battle of Camperdown and to Admiral Duncan.

Key development proposals include;

- Further development of the House to provide more extensive public access
- Exploration of the potential to develop a more significant Maritime Museum around the Battle of Camperdown.

7.6 **Camperdown Leisure Complex**

Camperdown Leisure Complex provides significant commercial leisure facilities including 9 screen UGC Cinema, Dundee Ice Arena, Hotel and Fast Food Outlets.

Key development proposals include;

- Development of further private sector led indoor leisure facilities.

7.7 **Watersports Centre: Clatto Reservoir**

Clatto Reservoir provides Dundee's watersports centre with a range of opportunities including canoeing and sailing provided from the Park's Visitor Centre. In addition coarse angling is available by day ticket on the Reservoir.

Key development proposals include;

- Improve visitor access to the Ranger Centre

7.8 **Woodland Natural Habitat Templeton Woods**

- 7.8.1 This mature woodland area provides an excellent habitat for many examples of Scottish wildlife. Roe deer, red squirrels, tawny owls and the elusive Jay can be seen by the careful observer. The Woodland Visitor Centre provides a central interpretation facility and the woods provide an extensive network of paths and trails suitable for walking, horse riding, cycling and orienteering.

7.8.2 Key development proposals include;

- Implement the Templeton Public Arts Strategy with provision of a waymarker route and supporting interpretive literature
- Refurbish ranger centre and enhance access and amenities
- Develop community woodland planting and management schemes
- Improve network of bridleways and trails including development of raised cycleway
- Implement the Red Squirrel Management Strategy

7.9 **Infrastructure**

7.9.1 The long term development of Camperdown Country Park requires consideration to be given to the sensitive development of the Park's infrastructure to support the growing public usage of this Green Space, as well as to best utilise the Park's significant assets.

7.9.2 Key development proposals include;

- Review and upgrading of car parking provision to manage the growing volume of car based visitors.
- Innovative development of park water supply. Camperdown Country Park utilises significant water from the national supply. A project to tap into existing underground supplies beneath the park through a new "borehole" and water pump system will supply up to 90% of the Park's water and result in significant revenue savings.
- The Caravan Park has been mothballed for a number of years. This area provides a significant development opportunity to compliment the Family Attractions Area to the south of the Park. Further feasibility study work will be undertaken with a view to bringing forward options for development.

8.0 **CONSULTATION**

The Chief Executive, Depute Chief Executive (Finance), Depute Chief Executive (Support Services) and Assistant Chief Executive (Community Planning) have been consulted on this Report and are in agreement with its contents.

9.0 **BACKGROUND PAPERS**

9.1 None

STEVE GRIMMOND
DIRECTOR OF LEISURE AND ARTS
21 JULY 2004

Appendices:

Appendix 1	Country Park Plan
Appendix 2	Wildlife Centre Master Plan
Appendix 3	Family Attraction Area Master Plan

Copies of the Country Park Marketing Leaflet have been separately supplied to Members

CAMPERDOWN COUNTRY PARK PLAN - APPENDIX 1

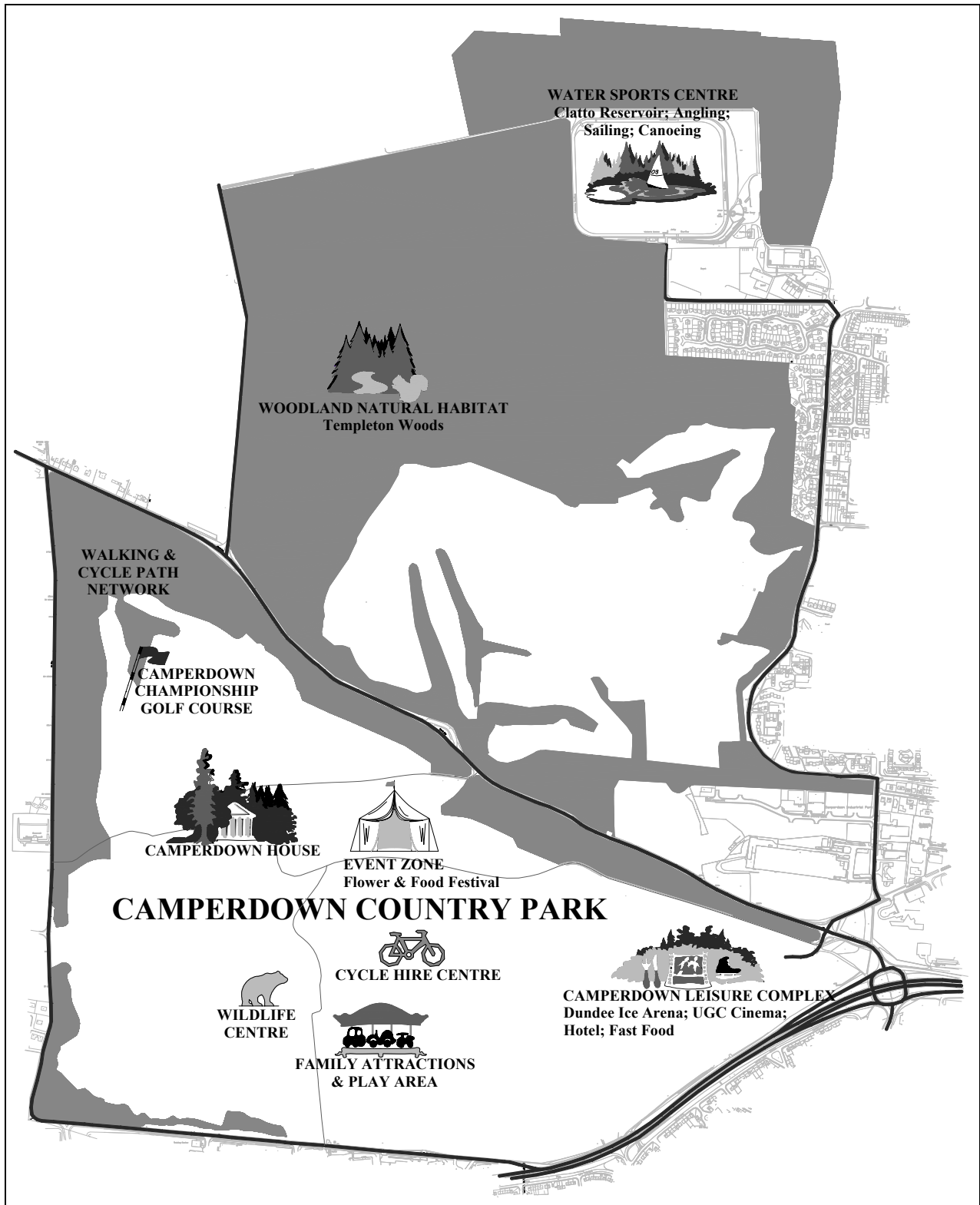

APPENDIX 2

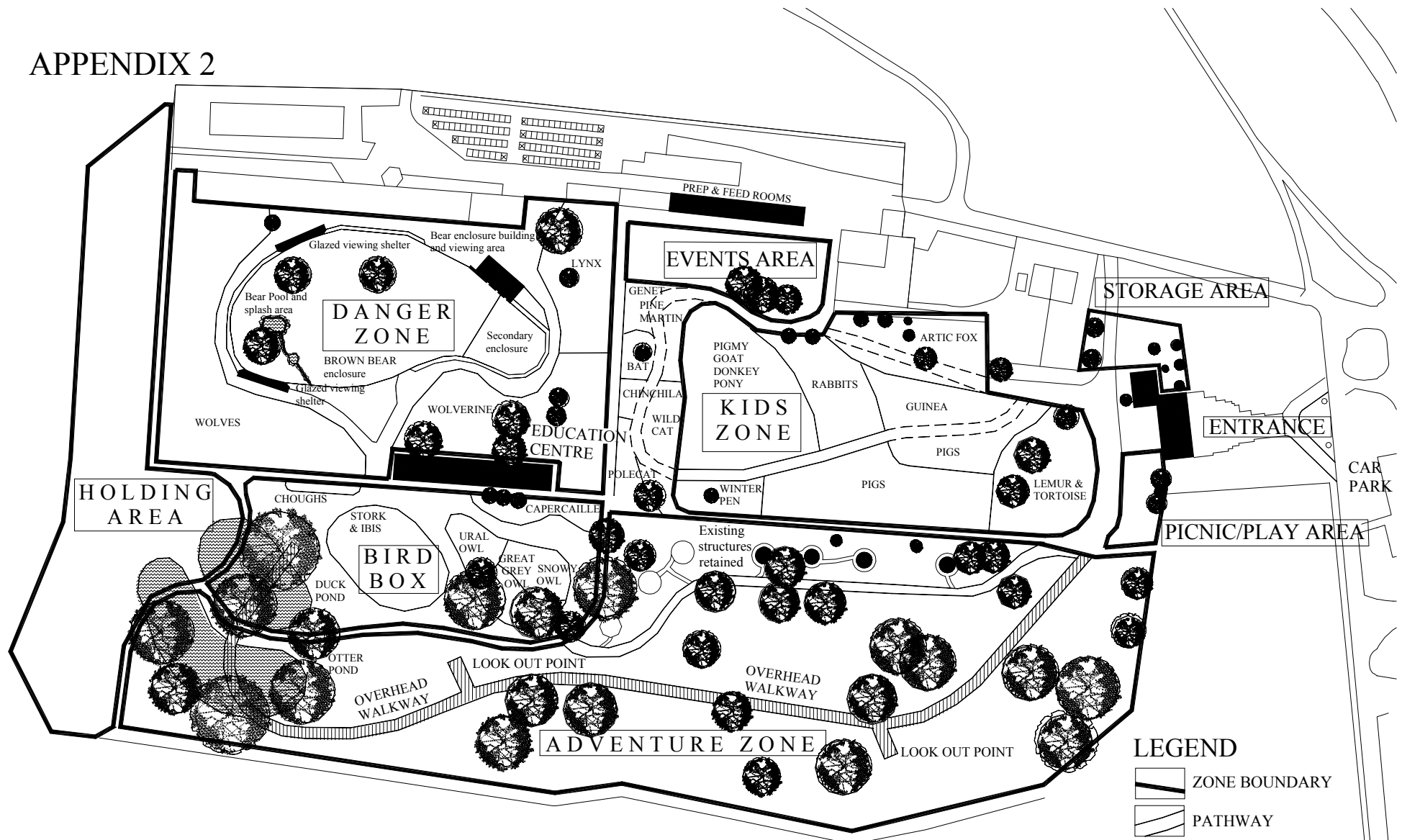

LEGEND

- ZONE BOUNDARY
- PATHWAY
- PATHWAY THROUGH ENCLOSURE
- EXISTING TREES
- WATER POOLS
- MAIN BUILDINGS

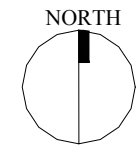

NOT TO SCALE

MASTERPLAN PROPOSALS CAMPERDOWN WILDLIFE CENTRE

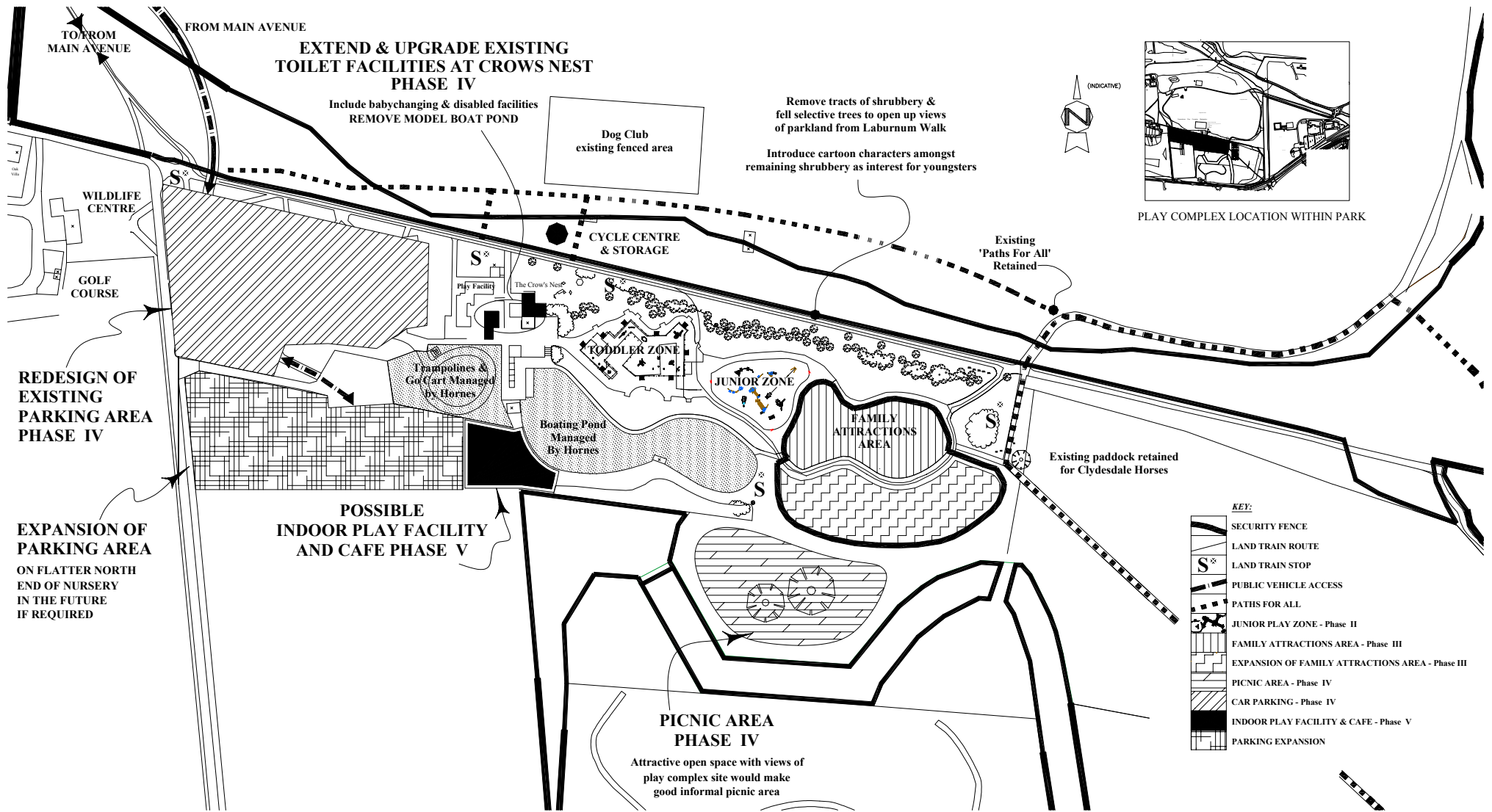

CAMPERDOWN COUNTRY PARK – PLAY COMPLEX MASTERPLAN

APPENDIX 3