

**REPORT TO: PLANNING AND TRANSPORTATION COMMITTEE
9 DECEMBER 2002**

**REPORT ON: BRINGING CONFIDENCE INTO PUBLIC TRANSPORT
NINEWELLS HOSPITAL INFRASTRUCTURE AND TRAFFIC
MANAGEMENT – JAMES BLACK PLACE**

REPORT BY: DIRECTOR OF PLANNING AND TRANSPORTATION

REPORT NO: 851-2002

1 PURPOSE OF REPORT

- 1.1 To illustrate the need for the preparation of a Traffic Regulation Order to restrict the use of this street for Public Transport.

2 RECOMMENDATIONS

- 2.1 Committee is asked to approve the following:-

The promotion of a Traffic Regulation Order to restrict the eastern turning area of this street to use by buses and taxis only, with provision for other users all as detailed on the attached drawing.

3 FINANCIAL IMPLICATIONS

- 3.1 The total cost of the works will be met from the successful Public Transport Fund Bid, "Bringing Confidence into Public Transport."

4 LOCAL AGENDA 21 IMPLICATIONS

- 4.1 The aim of Local Agenda 21 will be taken into consideration throughout the Bringing Confidence into Public Transport project. The components of the scheme will be designed and extensive consultations continue to be undertaken to ensure that public transport is at the forefront.

5 EQUAL OPPORTUNITIES IMPLICATIONS

- 5.1 The City Council continues to acknowledge the dominance of the private car within its transport network. The promotion of public transport, walking and cycle routes by measures included in this report aims to move towards redressing the balance for large numbers of our population who do not have access to the private car or who choose to undertake travel by other means.

6 BACKGROUND

- 6.1 The "Bringing Confidence into Public Transport" bid to the Scottish Executive was announced as successful in October 2001, with works to be implemented during the period April 2002 – March 2005.
- 6.2 Major infrastructure improvements at Ninewells formed part of the bid, complementary to Ninewells proposals to enhance the entrance foyer at the Hospital.

- 6.3 Dundee City Council Architects are commissioned for this part of the works.
- 6.4 Major reconstruction of James Black Place is required to withstand fully laden buses turning on the carriageway. The opportunity is to be taken to use robust materials for the construction, and with this investment it would be appropriate for the Council to then adopt this street for future maintenance. Tayside University Hospital Trust are in full agreement with this approach. The construction consent application will be the subject of a further report to Committee.
- 6.5 To ensure the efficient operation of the new bus facilities, it is proposed to restrict vehicular activity to public transport only (buses and taxis) with cyclists permitted also. All other users can set down and pick up at the new lay-by at the west end of the street, or at the existing designated area at the front door of the hospital.
- 6.6 Full details of the proposals are illustrated on the attached Drawing and a copy has been placed in the Members' Lounge.

7 CONSULTATIONS

- 7.1 Full consultation of the proposals, including the developing detailed design is ongoing with Tayside University Hospital Trust (TUHT).

8 BACKGROUND PAPERS

- 8.1 None.

Mike Galloway
Director of Planning & Transportation

Iain Sherriff
Roads & Transportation Manager

IFS/SA/EES

18 November 2002

Dundee City Council
Tayside House
Dundee

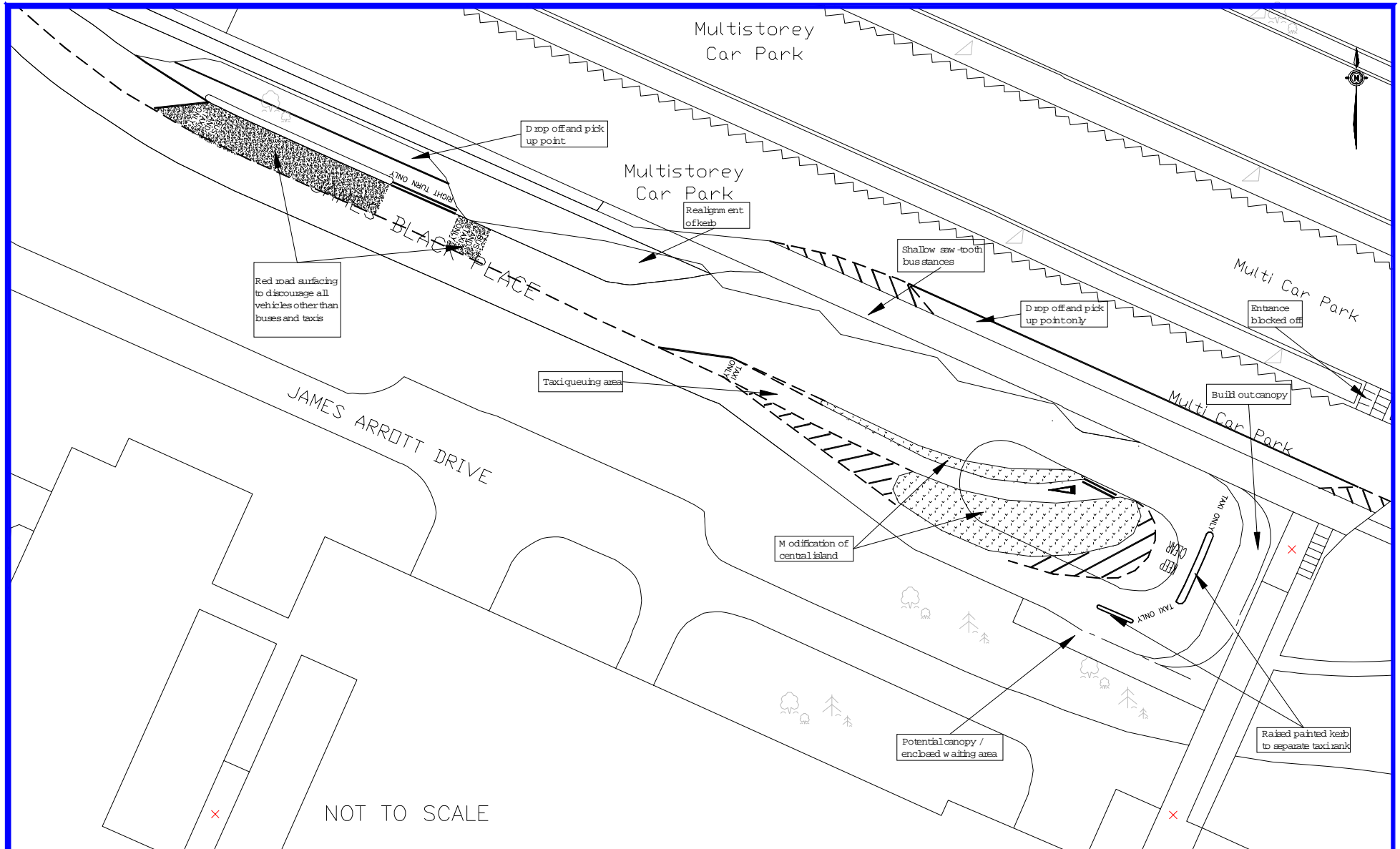

NOT TO SCALE

<p>JMP Consultants Ltd</p> <p>Consulting Civil, Structural and Transportation Engineers</p> <p>Minerva House East Parade Leeds West Yorkshire LS1 5PS</p> <p>Tel: 0113 - 2444347 Fax: 0113 - 2423753 Email: leeds@jmp.co.uk Website: www.jmp.co.uk</p>	Client		Project		Title		Drawing Status					
	DUNDEE.CITY.COUNCIL		NINEWELLS.HOSPITAL		JAMES.BLACK.PLACE		INFORMATION					
							Drawing Number. 030166/F/T/001					
<p>© This drawing is the property of JMP Consultants. This information can only be reproduced with prior permission of JMP Consultants Limited.</p> <p>© This drawing is based upon the Ordnance Survey Map with permission of the Controller of Her Majesty's Stationary Office Crown Copyright reserved.</p>		Scale	Original drg. size	Date	Drawn	Checked	Approved	Rev.				
		N.T.S	A3	DATE	DRAWN	CH'CKD	APPR'VD	REV				
									Rev.	Date	Revision Details	Drawn/Approved
									A	Sept 2002	Bus stance and red surfacing added	JM